

BIOSPHERE SUSTAINABILITY CENTRE

**CENTRE FOR SUSTAINABLE COMMUNITY
DEVELOPMENT**

**PUBLIC CONSULTATIONS
Status Report & Update - Gananoque**

NOVEMBER 18, 2009

PUBLIC CONSULTATION Agenda



- **Welcome & Purpose of Meeting**
- **Project History & Status Update**
- **What We Heard (Summary of Previous Consultations)**
- **Initial Conclusions re Space & Functional Programming**
- **Presentation of Examples of Sustainability Centres**
- **Q's and A's/Comments**
- **Next Steps**

HISTORY OF PROJECT



- 1. Biosphere brings together organizations with common interests, similar needs in programming, accommodation – synergy?**
- 2. Steering Committee established - Frontenac Arch Biosphere, Parks Canada, 1000 Islands Playhouse, Barbara Heck Foundation, public interests.**
- 3. Criteria developed for Centre, partners, community.**
- 4. Gananoque approached with offer – consider Textron/CamCar.**

ONE POSSIBLE OPTION

Re-use Camcar/Textron Site



HISTORY OF PROJECT



- 1. Biosphere brings together organizations with common interests, similar needs in programming, accommodation – synergy?**
- 2. Steering Committee established - Frontenac Arch Biosphere, Parks Canada, 1000 Islands Playhouse, Barbara Heck Foundation, public interests**
- 3. Criteria developed for Centre, partners, community**
- 4. Gananoque approached with offer – consider Textron/CamCar**
- 5. SC designed 3-part study – Visioning, Building Feasibility, Marketing/Economic Analysis**

Part 1 - Vision Document

- **Description of Centre concept & components of multi-use facility**
- **Proposed site and building schematic plans**
- **Conceptualized artistic renderings of site and building**
- **Programming ideas**
- **Examples of similar concepts/facilities and lessons learned**
- **Sustainable strategies including systems and innovative designs**

Part 2 - Building Feasibility Study

- **Logistical examination of proposed designs**
- **Results of project costing exercise**
- **Site and building feasibility with facility requirements**
- **Sustainable mechanical & electrical engineering design & LEED consultations**

Part 3 - Economic/Market Feasibility Study

•Economic Feasibility

- Determine feasibility of attracting market-based commercial tenants for synergies with components
- Assess current distribution of commercial uses in Biosphere Region
- Determine complementarities of possible commercial space with core activities of partners
- Review economic data on market
- Determine possible sources of public, private, & philanthropic funding

•Revenues/ Financial Opportunity

- Assess potential revenue from possible leasing of space
- Calculate projected possible revenues and projected costs – both construction and operating

•Marketing/ Tourism Study

- Assess demographic/socio-economic factors
- Determine target markets for tourism/travel to region
- Analyze profiles of & motivators for potential target markets

HISTORY OF PROJECT



- 1. Biosphere brings together organizations with common interests, similar needs in programming, accommodation – synergy?**
- 2. Steering Committee established - Frontenac Arch Biosphere, Parks Canada, 1000 Islands Playhouse, Barbara Heck Foundation, public interests.**
- 3. Criteria developed for Centre, partners, community.**
- 4. Gananoque approached with offer – consider Textron/CamCar.**
- 5. SC designed 3-part study – Visioning, Building Feasibility, Marketing/Economic Analysis.**
- 6. Provincial funding for study, Request for Proposals.**
- 7. Paul Raff Studios chosen, in partnership with Altus/Altus Costing, Environics Analytics, & Cobalt Engineering.**

HISTORY OF PROJECT (cont'd)

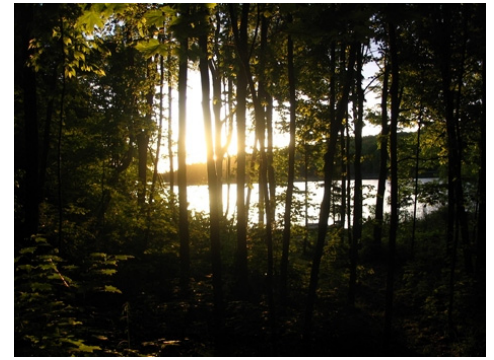

8. Public/stakeholder consultation – 3 Townhalls in September
9. Interviews with major Stakeholders
10. Analysis & research by Committee & Architectural team
11. November 18 Status Report & Update
 - Feedback on Consultations
 - Initial Conclusions on Space/Programming
 - More Examples of Sustainability Centres

 - Questions, Answers, Comments
 - Next Steps

TOWNHALL CONSULTATIONS

What We Heard

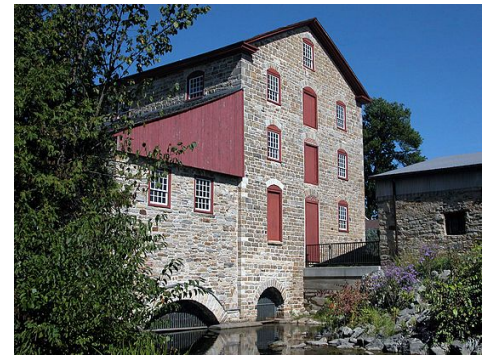

We like that the Centre would... (a summary)

- Rejuvenate the area & re-use an old industrial building.
- Create a focal point to explore & celebrate the Biosphere.
- Be space to collaborate, learn, create, exhibit; springboard to new initiatives.
- Become a world-class gateway to Eastern Ontario; a destination.
- Be possible incubator for economic development; generate new income.
- Not compete with but enhance other businesses.
- Enhance collaboration; generate enthusiasm around sustainability.
- Potentially be unique in the world; the first in a Biosphere.
- Be focal point for sustainability for both residents & visitors.
- An appropriate next step for Frontenac Arch Biosphere.

TOWNHALL CONSULTATIONS

What We Heard

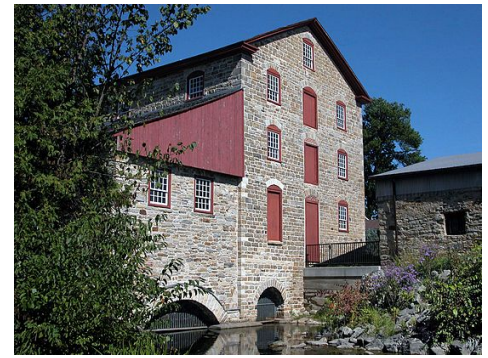

However, we have concerns... (a summary)

- Support from all levels of government: is it there? Financial & other?
- What are the Town's intentions for surrounding area?
- How do we get the whole region involved?
- Cost, financing factors: can we get this project off the ground?
- Internal governance factors: how to manage the Centre?
- Can project stay apolitical?
- Public involvement: need to bring in broad spectrum, families too.
- Ensure a positive impact on local business and regional attractions.
- Accessibility, parking, and landscaping issues.
- Can Centre/Region be a model of sustainability and promote understanding of concept/practice.

TOWNHALL CONSULTATIONS

What We Heard

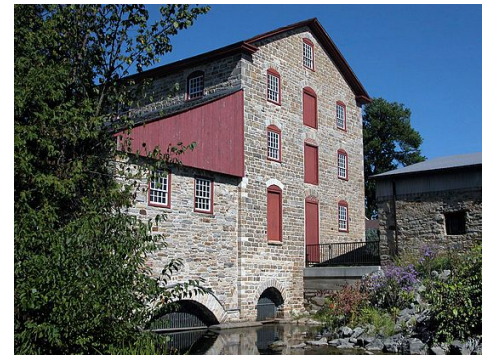

And, we have suggestions...

- Naturalize the parking lot.
- Appeal to all ages with galleries, extension activities.
- Be totally inclusive: for children, social services, aging society
- Link Centre to whole community.
- Appeal to people across the region, and to all types of business.
- Start with children to get sustainability messages across.
- Document the process as a model; a template for other communities.
- Include museum for culture of the area.
- Include a farmer's market, arts, galleries.
- Vigorously brand, market the Centre.
- Consult with educators – Queen's, St. Lawrence College, school boards.

INITIAL CONCLUSIONS

Space/Functional Programming



PAUL RAFF STUDIO INCORPORATED
ARCHITECTS

SUSTAINABILITY CENTRES

Other Examples

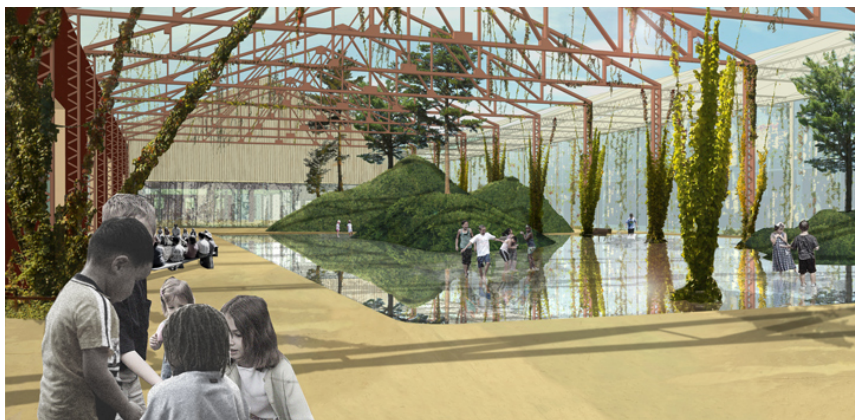

BIOSPHERE SUSTAINABILITY CENTRE



- **QUESTIONS?**
- **COMMENTS?**

BIOSPHERE SUSTAINABILITY CENTRE



Next Steps

- **Further interviews/analysis of feedback**
- **Further design by consultation team**
- **Final Report (all 3 phases) – mid-December**
- **Report posted on FAB web-site**
- **Follow-up/Further developments**

THANK YOU

**We Appreciate Your Continuing
Interest And Support.**